

1

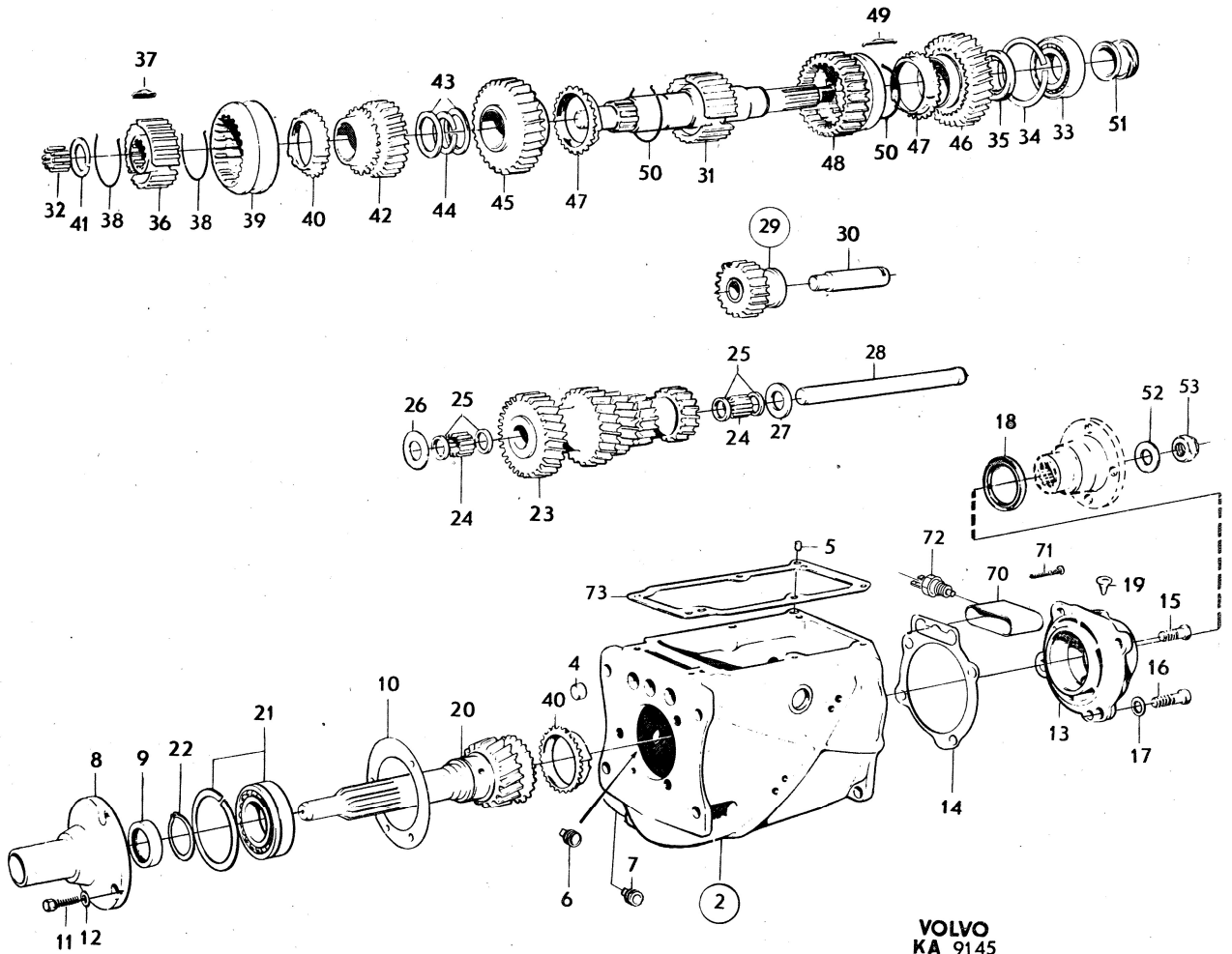
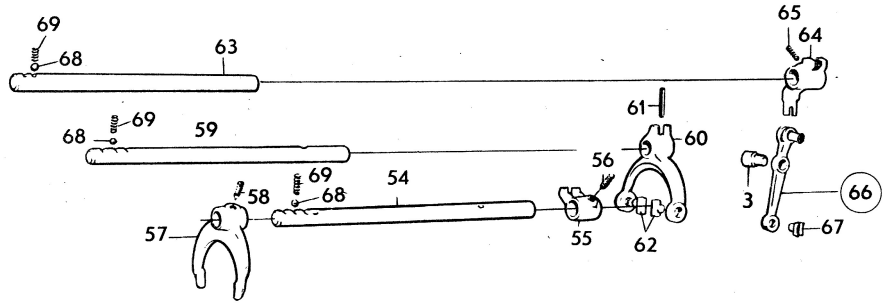

VOLVO
KA 9145

Sida Page	Grupp Group	Växellåda M40, GV	Gearbox M40, GV	Illustration 9145 1979-11	0450						
32	4										
Pos. Fig.	Antal/Quantity				Artikel nr Part No	Benämning	Description	Sats Kit	B P S R	Anmärkning Notes	
1	1	-	-	-	254652-1	Växellåda.....	Gearbox.....		8	ERS AV 1ST 1208005-7, 1ST 380449-9	1010 1011
2	1	-	-	-	380802-9	•Hus.....	•Housing.....		8	ERS AV 1ST 380998-5, 1ST 380887-1, 1ST 380878-9.	1020 1021 1022
3	1	-	-	-	656517-0	••Lagertapp.....	••Bearing pin.....				1030
4	3	-	-	-	191496-9	••Hattplugg.....	••Hat plug.....				1040
5	2	-	-	-	191529-7	••Pinne.....	••Pin.....				1050
6	1	-	-	-	952358-0	•Propp.....	•Plug.....				1060
7	1	-	-	-	951901-8	•Propp.....	•Plug.....				1070
8	1	-	-	-	380190-9	•Lock.....	•Cover.....				30
9	1	-	-	-	191685-7	•Tättningsring.....	•Seal ring.....	S			1090
x 10	1	-	-	-	380914-2	•Packning.....	•Gasket.....	S		(656505)	1100
11	3	-	-	-	192622-9	•Skruv.....	•Screw.....				1110
12	3	-	-	-	380381-4	•Gummiring.....	•Rubber ring.....				1120
x 13	1	-	-	-	381630-3	•Lock.....	•Cover.....			(380448)	1130
14	1	-	-	-	380800-3	•Packning.....	•Gasket.....	S			1140
15	3	-	-	-	955534-3	•Skruv.....	•Screw.....				1150
16	1	-	-	-	941939-1	•Skruv.....	•Screw.....				1160
17	4	-	-	-	18651-0	•Bricka.....	•Washer.....				1170
x 18	1	-	-	-	946341-5	•Tättningsring.....	•Seal ring.....	S		(942350)	1180
19	1	-	-	-	380211-3	•Luftningsnippel.....	•Air venting nipple.....				1190
20	1	-	-	-	380136-2	•Ingående axel.....	•Input shaft.....				1200
21	1	-	-	-	11145-0	•Kullager.....	•Ball bearing.....				1210
22	1	-	-	-		•Låsring, ALT.....	•Circlip, ALT.....				1220
	-	-	-	-	190737-7	•Låsring.....	•Circlip.....			TJ 2.0 MM	1230
	-	-	-	-	190814-4	•Låsring.....	•Circlip.....			TJ 2.1 MM	1240
	-	-	-	-	190815-1	•Låsring.....	•Circlip.....			TJ 2.2 MM	1250
	-	-	-	-	191105-6	•Låsring.....	•Circlip.....			TJ 2.3 MM	1260
23	1	-	-	-	380807-8	•Kugghjul.....	•Gear.....		8	ERS AV 1ST 380894-6, 1ST 380895-3.	1270 1271
24	42	-	-	-	183498-5	•Rulle.....	•Roller.....				1280
25	4	-	-	-	380809-4	•Distansring.....	•Spacer ring.....				1290
26	1	-	-	-	380813-6	•Tryckbricka.....	•Thrust washer.....				1300
27	1	-	-	-	380810-2	•Tryckbricka.....	•Thrust washer.....				1310
28	1	-	-	-	380808-6	•Axel.....	•Shaft.....				1320
29	1	-	-	-	380811-0	•Backdrev.....	•Reverse gear.....				1330
30	1	-	-	-	380615-5	•Axel.....	•Shaft.....			D 23,1	1340
31	1	-	-	-	380447-3	•Huvudaxel.....	•Main shaft.....				1350
32	14	-	-	-	181120-7	•Rulle.....	•Roller.....				1360
33	1	-	-	-	11024-7	•Kullager.....	•Ball bearing.....				1370
34	1	-	-	-		•Låsring, ALT.....	•Circlip, ALT.....				1380
	-	-	-	-	914537-6	•Låsring.....	•Circlip.....			TJ 2.5 MM	1390
	-	-	-	-	942339-3	•Låsring.....	•Circlip.....			TJ 2.6 MM	1400
	-	-	-	-	942340-1	•Låsring.....	•Circlip.....			TJ 2.7 MM	1410
35	1	-	-	-	380175-0	•Distansring.....	•Spacer ring.....				1420
x 36	1	-	-	-	380835-9	•Synkroniseringsnav.....	•Synchronizing hub.....			(380138)	1430
37	3	-	-	-	656514-7	•Medbringare.....	•Locating key.....				1440
38	2	-	-	-	86713-5	•Fjädderring.....	•Clamping ring.....				1450
39	1	-	-	-	656518-8	•Kopplingshylsa.....	•Engaging sleeve.....				1460
40	2	-	-	-	656138-5	•Synkroniseringskona.....	•Synchronizing cone.....				1470
41	1	-	-	-		•Låsring, ALT.....	•Circlip, ALT.....				1480
	-	-	-	-	191497-7	•Låsring.....	•Circlip.....			TJ 2.0 MM	1490
	-	-	-	-	191498-5	•Låsring.....	•Circlip.....			TJ 2.1 MM	1500
	-	-	-	-	191499-3	•Låsring.....	•Circlip.....			TJ 2.2 MM	1510
42	1	-	-	-	380619-7	•Kugghjul, 3-an.....	•Gear, 3rd.....				1520
43	2	-	-	-	380143-8	•Distansring.....	•Spacer ring.....				1530
44	1	-	-	-		•Låsring, ALT.....	•Circlip, ALT.....				1540
	-	-	-	-	191493-6	•Låsring.....	•Circlip.....			TJ 2.55 MM	1550
	-	-	-	-	191494-4	•Låsring.....	•Circlip.....			TJ 2.65 MM	1560
	-	-	-	-	191495-1	•Låsring.....	•Circlip.....			TJ 2.75 MM	1570
45	1	-	-	-	380174-3	•Kugghjul, 2-an.....	•Gear, 2nd.....				1580
46	1	-	-	-	380150-3	•Kugghjul, 1-an.....	•Gear, 1st.....				1590

Sida Page	Grupp Group	Växellåda M40, GV	Gearbox M40, GV	Illustration 9145 1979-11	0450						
34	4										
Pos. Fig.	Antal/Quantity				Artikel nr Part No	Benämning	Description	Sats Kit	B P S R	Anmärkning Notes	
	254 652										
47	2	-	-	-	656138-5	•Synkroniseringskona.....	•Synchronizing cone.....				1600
48	1	-	-	-	380142-0	•Kopplingshylsa.....	•Engaging sleeve.....				2010
49	3	-	-	-	380141-2	•Medbringare.....	•Locating key.....				2020
50	2	-	-	-	86713-5	•Fjädering.....	•Clamping ring.....				2030
51	1	-	-	-	380449-9	•Hastighetsmätardrev.....	•Speedometer gear.....				2040
52	1	-	-	-	80513-5	•Bricka.....	•Washer.....				2050
53	1	-	-	-	88726-5	•Mutter.....	•Nut.....				2060
54	1	-	-	-	380240-2	•Skiftaxel,3-an,4-an.....	•Shiftrail,3-rd,4-th.....				2070
55	1	-	-	-	380133-9	•Medbringare.....	•Dog.....				2080
56	1	-	-	-	656553-5	•Låsskruv.....	•Lock screw.....				2090
57	1	-	-	-	656537-8	•Skiftgaffel.....	•Shift fork.....				2100
58	1	-	-	-	656553-5	•Låsskruv.....	•Lock screw.....				2110
59	1	-	-	-	380131-3	•Skiftaxel,1-an,2-an.....	•Shift rail,1-st,2-nd.....				2120
60	1	-	-	-	380132-1	•Skiftgaffel.....	•Shift fork.....				2130
61	1	-	-	-	951965-3	•Spännstift.....	•Tensioner pin.....				2140
62	2	-	-	-	656549-3	•Medbringartapp.....	•Flange pin.....				2150
63	1	-	-	-	380231-1	•Skiftaxel,back.....	•Shift rail,reverse.....				2160
64	1	-	-	-	380134-7	•Skiftgaffel.....	•Shift fork.....				170
65	1	-	-	-	656553-5	•Låsskruv.....	•Lock screw.....				2180
66	1	-	-	-	380622-1	•Hävarm.....	•Lever.....				2190
67	1	-	-	-	656549-3	•Medbringartapp.....	•Flange pin.....				2200
68	3	-	-	-	67089-3	•Kula.....	•Ball.....				2210
69	3	-	-	-	87972-6	•Fjäder.....	•Spring.....				2220
70	1	-	-	-	380799-7	•Skyddskåpa.....	•Casing.....				2230
71	2	-	-	-	950256-8	•Skruv.....	•Screw.....				2240
72	1	-	-	-	380360-8	•Backljuskontakt.....	•Back-up lamp contact.....				2250
73	1	-	-	-	381107-2	•Packning.....	•Gasket.....				2260
	1	-	-	-	275488-5	•Packningssats.....	•Gasket kit.....		S		2270