

1

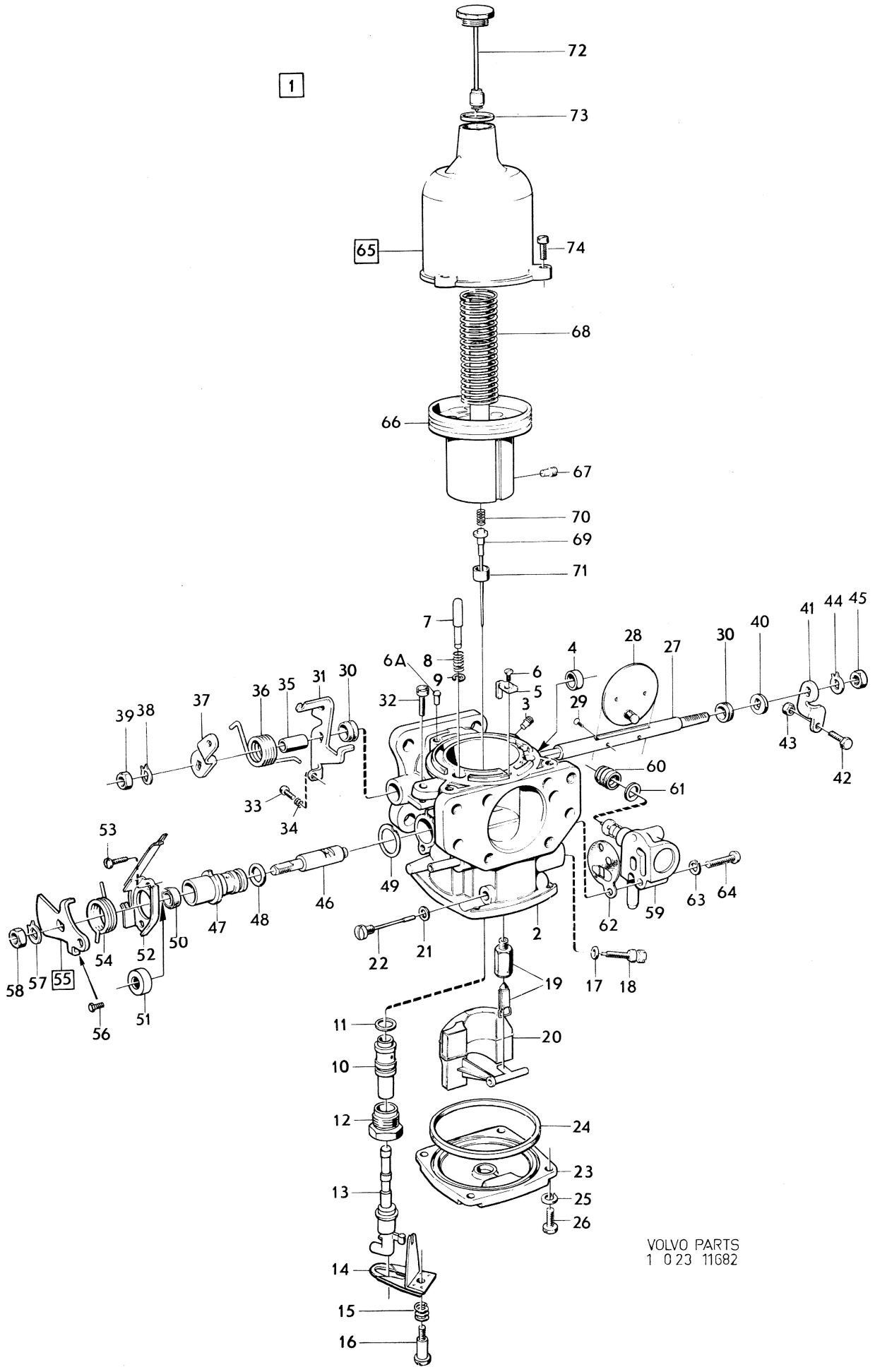

VOLVO PARTS  
1 0 23 11682



Sida	Grupp	Förgasare	Carburetter	Illustration 11682	0900					
70	2c									
Page	Group	1975-01								
Pos. Fig.	Antal/Quantity				Detalj nr Part No	Benämning	Description	Sats Kit	Anmärkning Notes	
	237 622	237 623	237 624							
1	1	-	-	-	237622-6	Förgasare, främre .....	Carburetter, front .....			1010
	-	1	-	-	237623-4	Förgasare, främre .....	Carburetter, front .....			1020
	-	-	1	-	237624-2	Förgasare, bakre .....	Carburetter, rear .....			1030
2	1	1	1	-		•Hus .....	•Housing .....	8		1040
3	1	1	-	-	237568-1	•Propp .....	•Plug .....			1050
4	2	2	2	-	237605-1	•Bussning .....	•Bushing .....			1060
5	1	1	1	-	237184-7	•Kil .....	•Key .....			1070
6	1	1	1	-	237185-4	•Skruv .....	•Screw .....			1080
6a	1	1	1	-	237104-5	•Nippel .....	•Nipple .....			1090
7	1	1	1	-	237617-6	•Pinne .....	•Pin .....			1100
8	1	1	1	-	237042-7	•Fjäder .....	•Spring .....			1110
9	1	1	1	-	237618-4	•Spärryttare .....	•Circlip .....			1120
10	1	1	1	-	237490-8	•Lagerhylsa .....	•Bearing .....			1130
11	1	1	1	-	237491-6	•Packning .....	•Packing .....			1140
12	1	1	1	-	237492-4	•Skruv .....	•Screw .....			1150
13	1	1	-	-	237592-1	•Munstycke .....	•Jet .....			1160
	-	-	1	-	237593-9	•Munstycke .....	•Jet .....			1170
14	1	1	1	-	237500-4	•Bimetallfjäder .....	•Bi-metal .....			1180
15	1	1	1	-	237501-2	•Fjäder .....	•Spring .....			1190
16	1	1	1	-	237502-0	•Skruv .....	•Screw .....			1200
17	1	1	1	-	237504-6	•O-ring .....	•O-ring .....			1210
18	1	1	1	-	237503-8	•Justerskruv .....	•Adjuster screw .....			1220
19	1	1	1	-	237569-9	•Nålventil med säte .....	•Needle valve with seat .....			1230
20	1	1	-	-	237495-7	•Flottör .....	•Float .....			1240
	-	-	1	-	237496-5	•Flottör .....	•Float .....			1250
21	1	1	1	-	237498-1	•Packning .....	•Packing .....			1260
22	1	1	1	-	237497-3	•Flottöraxel .....	•Spindle .....			1270
23	1	1	1	-	237594-7	•Lock .....	•Cover .....			1280
24	1	1	1	-	237506-1	•Gummiring .....	•Rubber ring .....			1290
25	4	4	4	-	955918-8	•Fjäderbricka .....	•Spring washer .....			1300
26	4	4	4	-	237507-9	•Skruv .....	•Screw .....			1310
27	1	1	1	-	237508-7	•Spjällaxel .....	•Spindle .....			1320
28	1	1	1	-	237577-2	•Spjällskiva .....	•Throttle disc .....			1330
29	2	2	2	-	943781-5	•Skruv .....	•Screw .....			1340
30	2	2	2	-	237510-3	•Tätningarring .....	•Seal ring .....			1350
31	1	1	-	-	237511-1	•Hävarm .....	•Lever .....			1360
	-	-	1	-	237578-0	•Hävarm .....	•Lever .....			1370
32	1	1	1	-	237513-7	•Justerskruv .....	•Adjuster screw .....			1380
33	1	1	1	-	237085-6	•Justerskruv .....	•Adjuster screw .....			1390
34	1	1	1	-	71856-9	•Fjäder .....	•Spring .....			1400
35	1	1	1	-	237514-5	•Distanshylsa .....	•Distance sleeve .....			1410
36	1	1	-	-	237606-9	•Returfjäder .....	•Spring .....			1420
	-	-	1	-	237607-7	•Returfjäder .....	•Spring .....			1430
37	1	1	-	-	237625-9	•Hävarm .....	•Lever .....			1440
	-	-	1	-	237626-7	•Hävarm .....	•Lever .....			1450
38	1	1	1	-	237467-6	•Låsbricka .....	•Lock washer .....			1460
39	1	1	1	-	237468-4	•Mutter .....	•Nut .....			1470
40	1	1	1	-	237579-8	•Distansbricka .....	•Distance washer .....			1480
41	1	1	-	-	237519-4	•Hävarm .....	•Lever .....			1490
	-	-	1	-	237520-2	•Hävarm .....	•Lever .....			1500
42	1	1	1	-	237521-0	•Justerskruv .....	•Adjuster screw .....			1510
43	1	1	1	-	237522-8	•Låsmutter .....	•Lock nut .....			1520
44	1	1	1	-	237467-6	•Låsbricka .....	•Lock washer .....			1530
45	1	1	1	-	237468-4	•Mutter .....	•Nut .....			1540
46	1	1	1	-	237595-4	•Ventilspindel .....	•Valve spindle .....			1550
47	1	1	1	-	237596-2	•Ventilhylsa .....	•Valve sleeve .....			1560
48	1	1	1	-	237527-7	•O-ring .....	•O-ring .....			1570
49	1	1	1	-	237528-5	•Packning .....	•Packing .....			2010
50	1	1	1	-	237510-3	•Tätningarring .....	•Seal ring .....	S		2020
51	1	1	1	-	237597-0	•Styrning .....	•Guide .....	S		2030
52	1	1	-	-	237608-5	•Hållare .....	•Retainer .....			2040
	-	-	1	-	237609-3	•Hållare .....	•Retainer .....			2050
53	2	2	2	-	237531-9	•Skruv .....	•Screw .....			2060



Sida 72 Grupp 2c Förgasare Carburetter Illustration 11682 0900  
Page Group 1975-01

Pos. Fig.	Antal/Quantity				Detalj nr Part No	Benämning	Description	Sats Kit	Anmärkning Notes	
	237 622	237 623	237 624							
54	1	1	-	-	237532-7	•Returfjäder .....	•Return spring .....			2070
	-	-	1	-	237583-0	•Returfjäder .....	•Return spring .....			2080
55	1	1	-	-	237584-8	•Hävarm .....	•Lever .....			2090
	-	-	1	-	237585-5	•Hävarm .....	•Lever .....			2100
56	1	1	1	-	955225-8	•Skruv .....	•Screw .....			2110
57	1	1	1	-	237467-6	•Låsbricka .....	•Lock washer .....	S		2120
58	1	1	1	-	237468-4	•Mutter .....	•Nut .....			2130
59	1	1	-	-	237534-3	•Ventilationshus .....	•Ventilator housing .....			2140
	-	-	1	-	237535-0	•Ventilationshus .....	•Ventilator housing .....			2150
60	1	1	1	-	237604-4	•Gummitätning .....	•Rubber seal .....			2160
61	1	1	1	-	955894-1	•Bricka .....	•Washer .....			2170
62	1	1	-	-	237539-2	•Packning .....	•Packing .....	S		2180
	-	-	1	-	237540-0	•Packning .....	•Packing .....	S		2190
63	2	2	2	-	955918-8	•Fjäderbricka .....	•Spring washer .....			2200
64	2	2	2	-	237541-8	•Skruv .....	•Screw .....			2210
65	1	1	1	-	237404-9	•Vakuumpkammare .....	•Vacuum chamber .....			2220
66	1	1	1	-		•Kolv .....	•Piston .....	8		2230
67	1	1	1	-	237614-3	•Skruv .....	•Screw .....	S		2240
68	1	1	1	-	71816-3	•Fjäder .....	•Spring .....			2250
69	1	1	1	-	237550-9	•Bränslenål .....	•Jet needle .....			2260
70	1	1	1	-	237405-6	•Fjäder .....	•Spring .....			2270
71	1	1	1	-	237615-0	•Styrning .....	•Guide .....			2280
72	1	1	1	-	237144-1	•Dämpare .....	•Damper .....			2290
73	1	1	1	-	190349-1	•Packning .....	•Packing .....		TID UTF	2300
74	1	1	1	-	237084-9	•Skruv .....	•Screw .....	S		2310
	-	-	-	-	276302-7	Reparationssats .....	Repair kit .....	S	1)	2320