

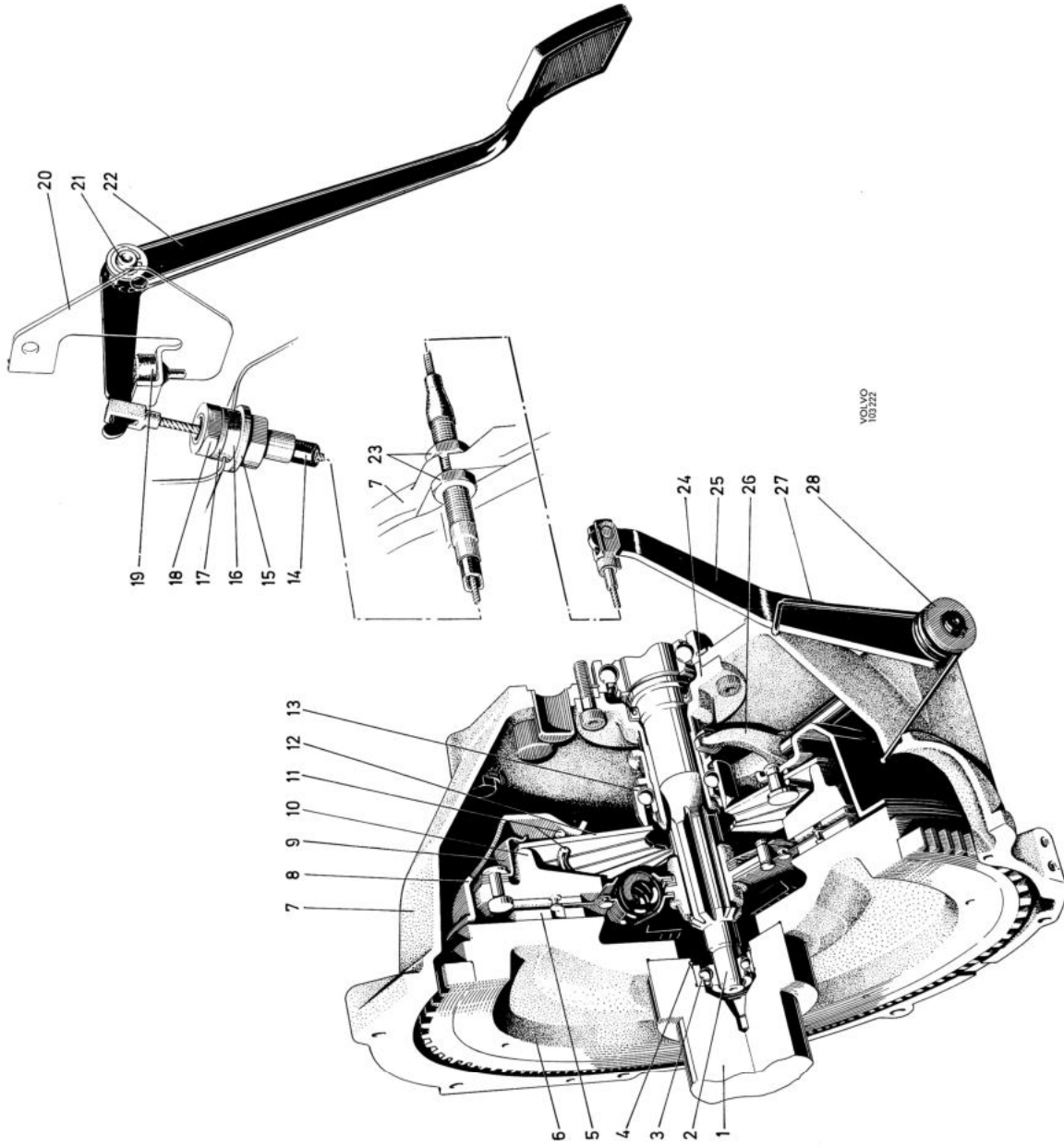

SERVICE MANUAL

VOLVO 164 1971



VOLVO
1032E

- 1. Crankshaft
- 2. Clutch plate shaft (input shaft, gearbox)
- 3. Support bearing in crankshaft
- 4. Circlip
- 5. Clutch plate
- 6. Flywheel
- 7. Flywheel casing
- 8. Clutch cover
- 9. Retainer
- 10. Thrust plate
- 11. Support rings
- 12. Pressure spring
- 13. Release bearing
- 14. Clutch wire
- 15. Washer
- 16. Rubber bush
- 17. Washer
- 18. Nut
- 19. Rubber stop
- 20. Stop bracket
- 21. Pedal shaft
- 22. Clutch pedal
- 23. Adjusting nuts
- 24. Cover, gearbox
- 25. Lever and release shaft
- 26. Release fork
- 27. Return spring
- 28. Washer

Illustration 4-A. Clutch and clutch controls