

st. op licht

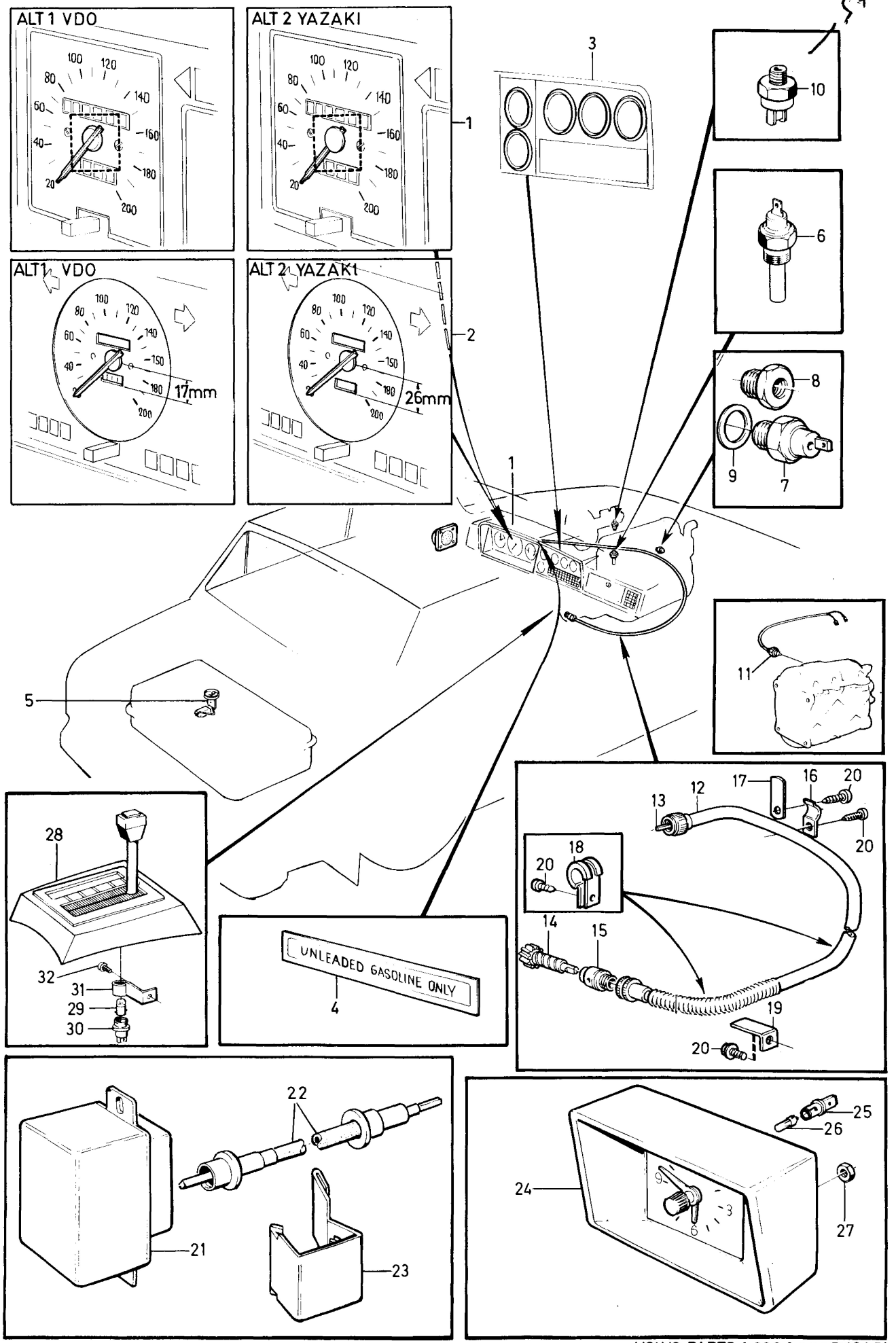

Sida Page	Grupp Group	Instrumentering, instrumentutrustning, övrig inre utrustning				Instrumentation, instrument equipment, miscellaneous interior equipment			Illustration 33935 1984-12	1800	
166	3										
Pos. Fig.	Antal/Quantity				Artikel nr Part No	Benämning	Description	Sats Kit	B P S R	Anmärkning Notes	
	4CYL DIES VST	4CYL DIES HST	6CYL VST	6CYL HST							
1	-	-	-	-		Kombinerat instrument	Combined instrument			14)	0020
2	-	-	-	-		Kombinerat instrument	Combined instrument			SE SIDA 170, 3-H03 15)	0040
3	-	-	-	-		Extra instrument	Extra instrument			SE SIDA 178, 3-H11 15)	0060 0080
4	1	1	1	1	1202390-9	GT-INSTRUMENT S kylt, (unleaded gasoline only)	GT-INSTRUMENT Plate, (unleaded gasoline only)	3		SE SIDA 182, 3-H15 SE SIDA 188, 3-H21 CALIFORNIA	0100 0120 0140 0160 0180
	1	1	1	1	1255865-6	S kylt, (unleaded gasoline only)	Plate, (unleaded gasoline only)	3		CAN	0200
5	-	-	-	-		Tankarmatur	Fuel gauge sender			SE GRUPP 2C	0200
6	1	1	-	-	460191-0	Temperaturgivare	Temperature sender	2		EXCL D24	0260
	2	-	-	-	1257617-9	Temperaturgivare	Temperature sender	8		D24 ERS AV 1 ST 1328397-3 1 ST 18665-0	0280 0300 0320
	-	-	-	-						D24 SERVICE ALT.	0380
	2	-	-	-	1328397-3	Temperaturgivare	Temperature sender	2			0400
	-	-	-	-	269085-7	Temperaturgivare	Temperature sender	2			0420
	1	1	-	-		Temperaturgivare	Temperature sender	8		B21F CHRYSLER IGNITION	0440
7	1	1	-	-	1324750-7	tändsystem, vatten	ignition, water				0460
	-	-	-	-	1218190-5	Oljetryckskontakt	Oil pressure contact	2		EXCL D24 (1266085)	0480
	1	-	-	-	1257137-8	Oljetryckskontakt	Oil pressure contact	2			0500
8	-	-	1	1	464592-5	Plugg	Plug	6		D24 ALT	0520 0540
9	-	-	1	1	11998-2	Packning	Packing	1		(1218022)	0560
	1	-	-	-	946532-9	Packning	Packing	2		D24	0580
10	1	1	-	-	679364-0	Bromskontakt	Brake contact	1			0590
11	-	-	-	-		Strömställare, backlampa	Switch, reverse lamp			SE GRUPP 4	0600 0620 0640 0660 0680 0700 0720 0740 0760 0780 0800 0820
12	-	-	-	-		HASTIGHETSMÄTAR- WIRE VDO	SPEEDOMETER WIRE VDO			9)	0840 0860 0880 0900 0920 0940 0960 0980
	1	-	-	-	1215548-7	Drivaxel	Drive cable	1		M45 EXCL D24 SWEDEN	0660
	1	-	-	-	1235804-0	Drivaxel	Drive cable	1		M45 D24 SWEDEN	0680
	1	-	-	-	1215546-1	Drivaxel	Drive cable	1		M46 EXCL D24 SWEDEN	0700
	1	-	-	-	1235805-7	Drivaxel	Drive cable	1		M46 D24 SWEDEN	0720
	1	-	-	-	1234490-9	Drivaxel	Drive cable	1		M47, AW/BW55, AW70/71 EXCL D24 SWEDEN	0740 0760 0780
	1	-	-	-	1235803-2	Drivaxel	Drive cable	1		AW/BW55, AW70/71 D24 SWEDEN	0800 0820
	-	-	-	-	1234256-4	Drivaxel	Drive cable	1		M45	0840
	-	-	-	-	1234254-9	Drivaxel	Drive cable	1		M46	0860
	-	-	-	-	1234255-6	Drivaxel	Drive cable	1		M47, AW/BW55	0880
	-	-	1	-	1234256-4	Drivaxel	Drive cable	1		12) M45	0900
	-	-	1	-	1234254-9	Drivaxel	Drive cable	1		12) M46	0920
	-	-	1	-	1234255-6	Drivaxel	Drive cable	1		13) M45, M46	0940
	-	-	1	-	1234255-6	Drivaxel	Drive cable	1		M47	0960
	-	-	1	-	1234254-9	Drivaxel	Drive cable	1		BW55	0980
	-	-	-	-	1234775-3	Drivaxel	Drive cable	1		M45	0960
	-	-	-	-	1234255-6	Drivaxel	Drive cable	1		M46	0980

9. Hastighetsmätarens visare, utförande enligt ALT 1 på bildsidan. Speedometer pointer, as illustrated as ALT 1 on illustration. Indicateur de compteur de vitesse, version selon ALT 1 sur la page de figure. Ausführung des Tachometerzeigers lt. ALT 1 auf der Bildseite. Indicador velocimetro, modelo según ALT 1 en las páginas de ilustraciones. Lancetta tachimetro, esecuzione secondo ALT 1 sulla pag. immagini.
12. 242 CH-165569, 244 CH-482504, 245 CH-264754, 262 CH-6449, 264 CH-83054, 265 CH-21774.
13. 242 CH-165570-, 244 CH-482505-, 245 CH-264755-, 262 CH-6450-, 264 CH-83055-, 265 CH-21775-.
14. 242 CH-189179, 244 CH-592109, 245 CH-317939, 262 CH-8374, 264 CH-107609, 265 CH-28319.
15. 242 CH-189180-, 244 CH-592110-, 245 CH-317940-, 262 CH-8375-, 264 CH-107610-, 265 CH-28320-.

Sida Page		Grupp Group				Instrumentering, instrumentutrustning, övrig inre utrustning		Instrumentation, instrument equipment, miscellaneous interior equipment			Illustration 33935 1984-12		1800
Pos. Fig.	Antal/Quantity				Artikel nr Part No	Benämning	Description	Sats Kit	B P S R	Anmärkning Notes			
	4CYL DIES VST	4CYL DIES HST	6CYL VST	6CYL HST									
	-	-	-	1	1214496-0	Drivaxel.....	Drive cable.....	1		BW55		1000	
	-	-	-	-		HASTIGHETSMÄTAR- WIRE YASAKI	SPEEDOMETER WIRE YAZAKI			10)		1020 1040 1060 1080 1100	
	1	-	-	-	1215561-0	Drivaxel.....	Drive cable.....	1		M45		1120	
	1	-	-	-	1214859-9	Drivaxel.....	Drive cable.....	1		M46		1140	
	1	-	-	-	1215563-6	Drivaxel.....	Drive cable.....	1		M47, AW/BW55		1160	
	-	1	-	-	1258620-2	Drivaxel.....	Drive cable.....	1		M45, M46		1180	
	-	1	-	-	1234596-3	Drivaxel.....	Drive cable.....	1		AW/BW55		1200	
	-	-	-	1	1234596-3	Drivaxel.....	Drive cable.....	1		M46		1220	
	-	-	-	1	1234597-1	Drivaxel.....	Drive cable.....	1		BW55		1240	
13	1	1	1	1		.Drivlina.....	.Drive cable.....	8				1260	
	1	-	-	-	283131-1	Drivaxel, regulator- växellåda	Drive axle, charging relay-gear box	1		262C		1280 1300	
14	-	-	-	-		Hastighetsmätardrev.....	Speedometer gear.....			SE GRUPP 4		1320	
15	-	-	-	-		Lagerhylsa.....	Bearing cap.....			SE GRUPP 4		1340	
16	1	-	1	-	1233372-0	Klammer.....	Clamp.....	2		EXCL D24 SWEDEN		1360	
17	1	-	-	-	948524-4	Klammer.....	Clamp.....	2		D24 SWEDEN UCOMBU		1380	
18	ERF	ERF	ERF	ERF	952624-5	Klammer.....	Clamp.....	2		ALT1. DI 7,9 MM		1400	
	ERF	ERF	ERF	ERF	952626-0	Klammer.....	Clamp.....	2		ALT2. DI 11,1 MM		1420	
	ERF	ERF	ERF	ERF	952629-4	Klammer.....	Clamp.....	2		ALT3. DI 15,9 MM		1440	
19	1	1	1	1	1234773-8	Konsol.....	Bracket.....	3		AW/BW55		1460	
										EXCL D24 SWEDEN		1480	
20	ERF	ERF	ERF	ERF	965354-4	Skruv.....	Screw.....	2		ALT1. D10,L13		1500	
	ERF	ERF	ERF	ERF	945970-2	Skruv.....	Screw.....	2		ALT2. D14,L13		1520	
21	1	1	1	1	1308308-4	EGR-DON.....	EGR-UNIT.....	3		ALT USA (1258155)		1540	
						30000 miles	30000 miles					1560	
22	1	1	1	1	1308309-2	Drivaxel, EGR-DON.....	Drive axle, EGR-UNIT.....	3		(1215747)		1580	
23	1	1	1	1	1215748-3	Hållare, EGR-DON.....	Holder, EGR-UNIT.....	3				1600	
24	-	-	1	-	1235687-9	Klocka.....	Clock.....	3		262C		1620	
	1	1	1	1	1214918-3	Klocka.....	Clock.....	3		EXCL 262C		1640	
25	2	2	2	2	1234948-6	.Lamphållare.....	.Bulb socket.....	2				1660	
26	2	2	2	2	942327-8	.Glödlampa.....	.Bulb.....	1		(277747)		1680	
										W2X4,6D 12V 1,2W		1700	
27	2	2	2	2	955779-4	Mutter.....	Nut.....	2				1720	
28	1	1	1	1		Kåpa.....	Casing.....			VXL AUTO		1740	
										SE GRUPP 4		1760	
29	1	1	1	1	942327-8	Glödlampa.....	Bulb.....	1		(277747) VXL AUTO		1780	
										W2X4,6D 12V 1,2W		1800	
30	1	1	1	1	677292-5	Lamphållare.....	Bulb socket.....	2		VXL AUTO		1820	
31	1	1	1	1	381722-8	Konsol.....	Bracket.....	4		VXL AUTO		1840	
32	1	1	1	1	950007-5	Skruv.....	Screw.....	2		VXL AUTO		1860	

10. Hastighetsmätarens visare, utförande enligt ALT 2 på bildsidan Speedometer pointer, as illustrated as ALT 2 on illustration. Indicateur de compteur de vitesse, version selon ALT 2 sur la page de figure. Ausführung des Tachometerzeigers lt. ALT 2 auf der Bildseite. Indicador velocimetro, modelo según ALT 2 en las páginas de ilustraciones. Lancetta tachimetro, esecuzione secondo ALT 2 sulla pag. immagini.