

| | | | | | | | |
|-----------------|---|--------------------------------------|--|----------------|----|--------------|---|
| Utgåva Issue | 1 | FRAMSTYCKE, MOTORHUV, HUVLAS P130 | FRONT SECTION, BONNET, BONNET CATCH P130 | Grupp Group | 8A | Sida Page | 5 |
|-----------------|---|--------------------------------------|--|----------------|----|--------------|---|

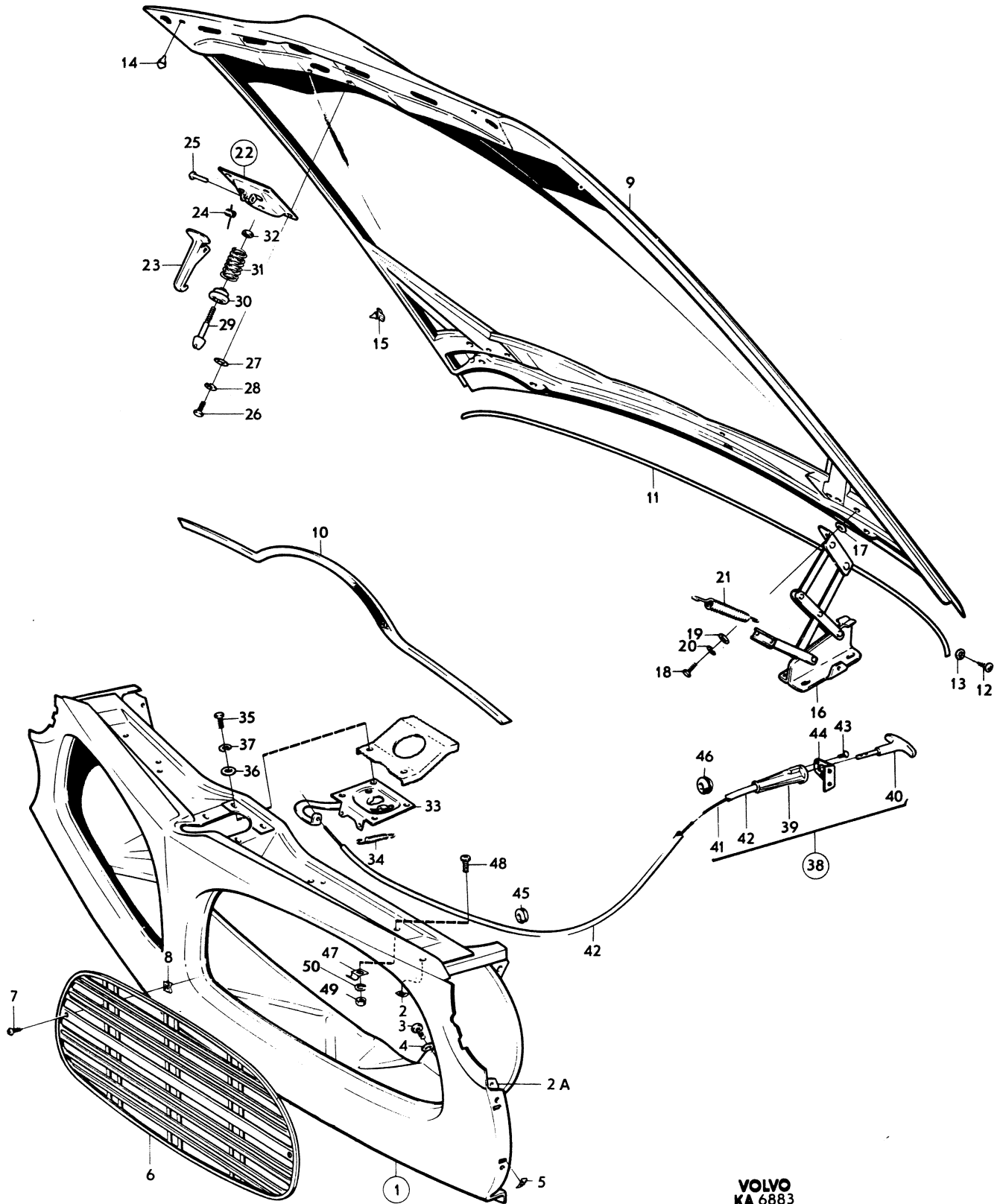



| Sida Page | | Grupp Group | | FRAMSTYCKE, MOTORHUV, HUVLAS P130 | | FRONT SECTION, BONNET, BONNET CATCH P130 | | Utgåva Issue | | |
|--------------|-----------|----------------|---|--------------------------------------|----------------------|--|--------------------------------|-----------------|---------------------|------------|
| 4 | | 8A | | | | | | 4 | | |
| Pos. Fig. | Antal Qty | | | | Detalj nr Part No | Benämning | Description | Sats / Kit | Anmärkning Notes | |
| | | | | | | | | | | |
| 1 | 1 | . | . | . | 663946-2 | FRAMSTYCKE | FRONT SECTION | 1 | | 010 |
| 2 | 2 | . | . | . | 941962-3 | .FJÄDERMUTTER | .SPRING NUT | 0 | | 020 |
| 2A | 1 | . | . | . | 672820-8 | .MUTTERPLATTA, V. | .NUT PLATE, L | | | 030 |
| | 1 | . | . | . | 672821-6 | .MUTTERPLATTA, H. | .NUT PLATE, R | | | 040 |
| 3 | 10 | . | . | . | 190665-0 | SKRUV, SJÄLVGÅNGANDE. | BOLT, TAPPING | S | | 050 |
| | 8 | . | . | . | 955523-6 | SKRUV | BOLT | 0 | 5/16-18 UNC TID UTF | 060 |
| | 8 | . | . | . | 942624-8 | FLANSSKRUV. | FLANGED BOLT. | 0 | 5/16-18 UNC SEN UTF | 061 |
| 4 | 10 | . | . | . | 120085-6 | BRICKA. | WASHER. | S | D 12 | 070 |
| | 8 | . | . | . | 955894-1 | BRICKA. | WASHER. | 0 | D 16 TID UTF | 080 |
| 5 | 6 | . | . | . | 191761-6 | PLÅTMUTTER. | SPEED NUT | S | | 090 |
| 6 | 1 | . | . | . | 672278-9 | GALLER, V | GRILLE, L | 1 | | 100 |
| | 1 | . | . | . | 672279-7 | GALLER, H | GRILLE, R | 1 | | 110 |
| 7 | 4 | . | . | . | 190388-9 | SKRUV | SCREW | S | | 120 |
| 8 | 4 | . | . | . | 192557-7 | FJÄDERMUTTER. | SPRING NUT. | S | | 130 |
| 9 | 1 | . | . | . | 660828-5 | MOTORHUV. | BONNET. | 2 | | 140 |
| 10 | 1 | . | . | . | 671629-4 | TÄTNINGSLIST. | SEAL MOULDING | 2 | | 150 |
| 11 | 1470 | . | . | . | 92510-7 | TÄTNINGSLIST. | SEAL MOULDING | 4 | METERVARA | 160 |
| 12 | 2 | . | . | . | 14939-3 | SKRUV | SCREW | 0 | | 170 |
| 13 | 2 | . | . | . | 955891-7 | BRICKA. | WASHER. | 0 | | 180 |
| 14 | 2 | . | . | . | 655545-2 | GUMMIKNAPP. | RUBBER BUTTON | 1 | | 190 |
| 15 | 6 | . | . | . | 656577-4 | GUMMIKNAPP. | RUBBER BUTTON | 1 | | 200 |
| 16 | 1 | . | . | . | 659394-1 | GANGJÄRN, V | HINGE, L. | 3 | | 210 |
| | 1 | . | . | . | 659395-8 | GANGJÄRN, H | HINGE, R. | 3 | | 220 |
| 17 | ERF | . | . | . | 955895-8 | BRICKA. | WASHER. | 0 | | 230 |
| 18 | 12 | . | . | . | 955534-3 | SKRUV | SCREW | 0 | | 240 |
| 19 | 8 | . | . | . | 955895-8 | BRICKA. | WASHER. | 0 | | 250 |
| 20 | 12 | . | . | . | 940108-4 | FJÄDERBRICKA. | SPRING WASHER | 0 | | 260 |
| 21 | 4 | . | . | . | 659816-3 | FJÄDER. | SPRING. | 3 | | 270 |
| 22 | 1 | . | . | . | 657796-9 | HUVLAS, ÖVERDEL | BONNET CATCH, UPPER SECTION | S | | 280 290 |
| 23 | 1 | . | . | . | 657797-7 | .FANGKROK | .CATCH. | | | 300 |
| 24 | 1 | . | . | . | 657798-5 | .FJÄDER | .SPRING | | | 310 |
| 25 | 1 | . | . | . | 191085-0 | .NIT. | .RIVET. | | | 320 |
| 26 | 4 | . | . | . | 955512-9 | SKRUV | SCREW | S | | 330 |
| 27 | 4 | . | . | . | 192287-1 | BRICKA. | WASHER. | S | | 340 |
| 28 | 4 | . | . | . | 955920-4 | FJÄDERBRICKA. | SPRING WASHER | S | | 350 |
| 29 | 1 | . | . | . | 657974-2 | STYRTAPP. | GUIDE PIN | S | | 360 |
| 30 | 1 | . | . | . | 657975-9 | ANSLAGSHYLSA. | FITTING SLEEVE. | 3 | | 370 |
| 31 | 1 | . | . | . | 88814-9 | FJÄDER. | SPRING. | S | | 380 |
| 32 | 1 | . | . | . | 940118-3 | MUTTER. | NUT | S | | 390 |

